

**VICINITY MAP**

**LEGEND**

SITE AREA: 0.649 ACRES
USES: PARKING
LANDSCAPING: PER PLAN
SCREENING: PER PLAN

Note: Lighting provisions for off-street parking may not exceed 20 feet in height and must comply with Section 51P-193.113(e).

Lemmon Avenue (100' R.O.W.)

Crestview Drive (53' R.O.W.)

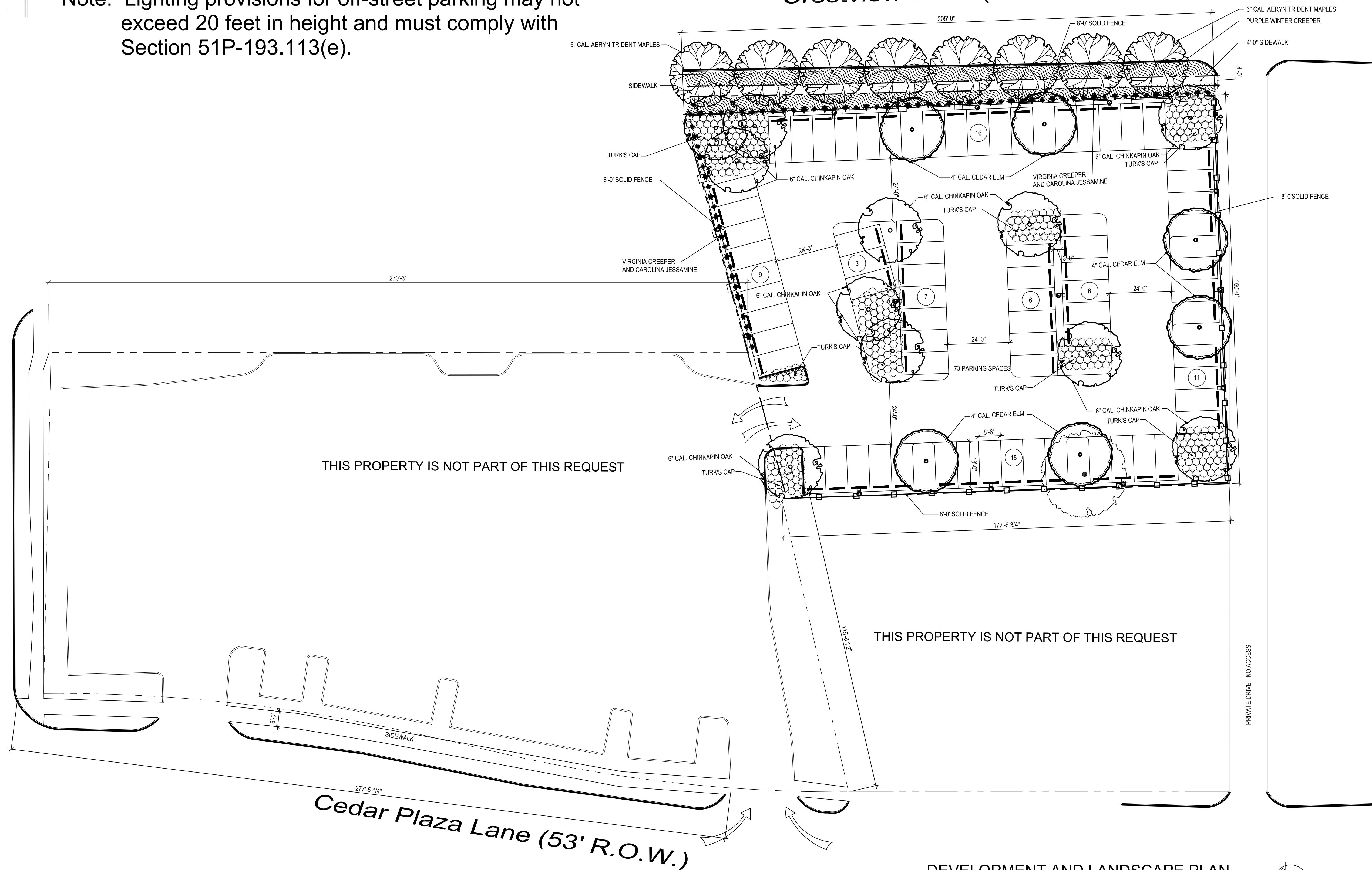

THIS PROPERTY IS NOT PART OF THIS REQUEST

THIS PROPERTY IS NOT PART OF THIS REQUEST

Cedar Plaza Lane (53' R.O.W.)

**01 DEVELOPMENT AND LANDSCAPE PLAN**  
1"=20'-0"

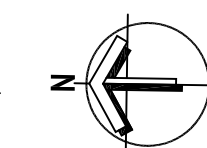

DATE	DESCRIPTION

**PRELIMINARY**  
THIS DOCUMENT SHALL NOT BE USED FOR REGULATORY APPROVAL, PERMIT, OR CONSTRUCTION. RELEASED UNDER THE AUTHORITY OF NICHOLAS K. CADE, TBAE LICENSE #9301

NCA JOB #: 14051

**DEVELOPMENT/  
LANDSCAPE  
PLAN**

**A000**